

Raster für Schraubbefestigung

Grid for wall mounting

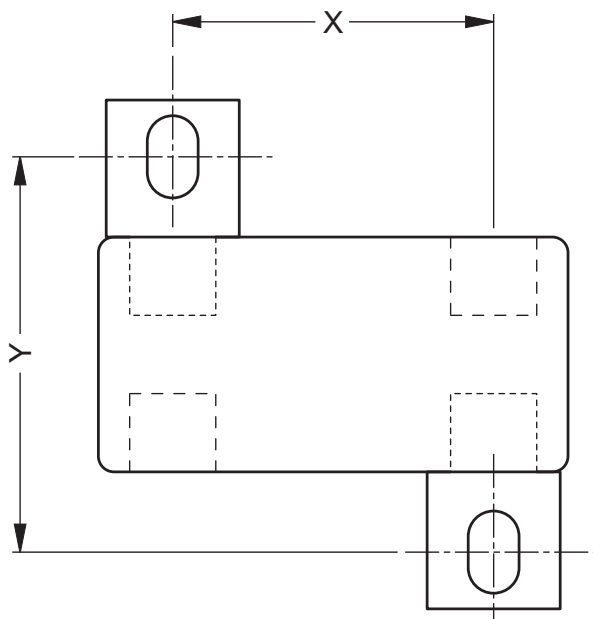
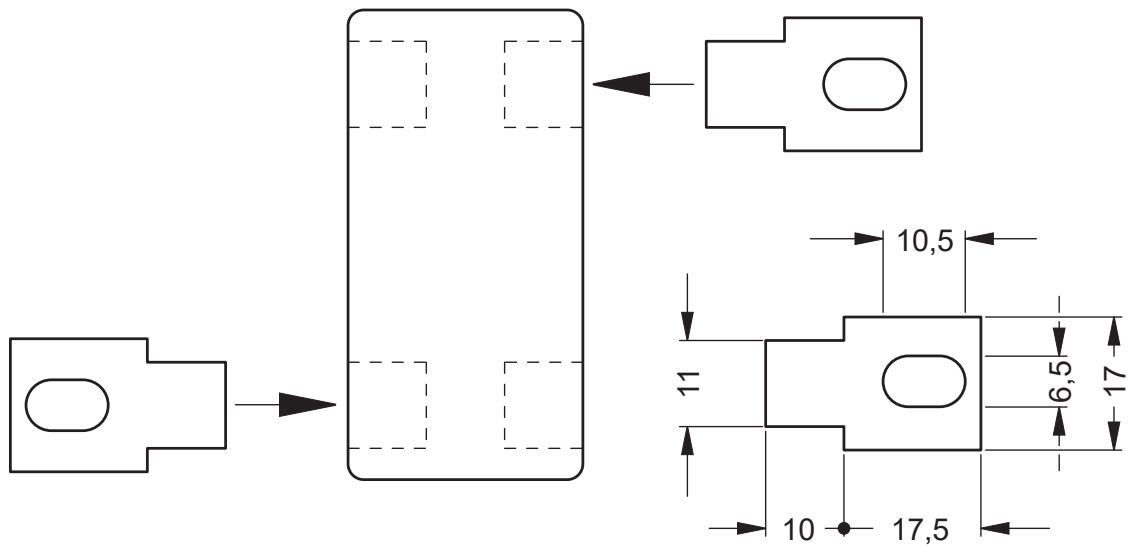

Wandlertyp CT type	x [mm]	y [mm]
6A315.3	40	50,5
7A412.3	50	50,5
8A512.3	59	50,5
9A615.3	69	50,5
13A1030.3	69	50,5

Wandlerdicke CT thickness	30 mm
------------------------------	-------