

# Moulded case current transformer, class 0,2S

**Increased safety**

- Both halves of the housing overlap rather than butting up against one another
- Burst-resistant plastic housing made from polyamide
- Non-combustible per UL 94 VO and self-extinguishing

**Protective caps for primary rail fastening screws**

- Screw-in pins for the primary rail terminals can be insulated by means of protective caps, available as an option
- Safeguard to prevent accidental contact

**Secondary connection feed**

- Feeding of the secondary connection to the connection terminals through the rectangular opening in the front and rear sides
- During installation, e.g. behind the safety strip, the secondary connection is implemented by means of cable lugs through the side slots

**Expanded secondary terminal covering**

- In addition to the normal terminal covering, extra protective hoods are available
- Locking of the front and rear feed to the secondary terminals



## Dimension diagrams

All dimensions in mm

IA60B31K

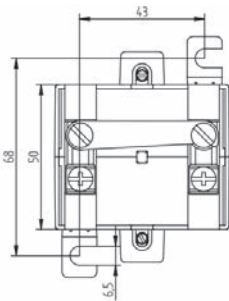

IA70B41K

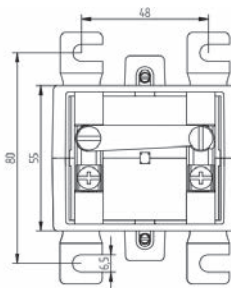

IA85B61K

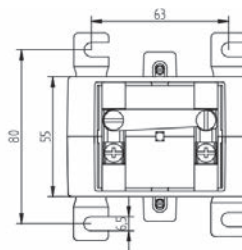

IA140A102

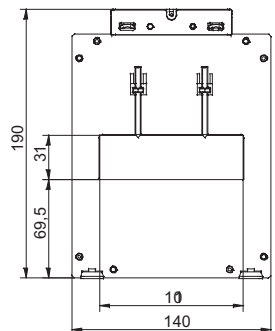
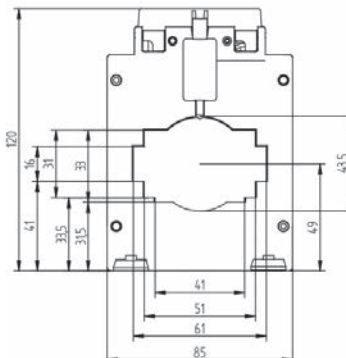
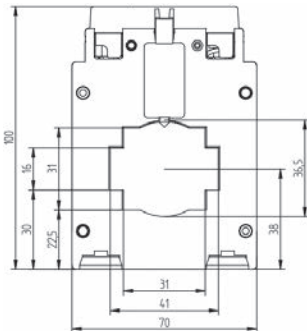
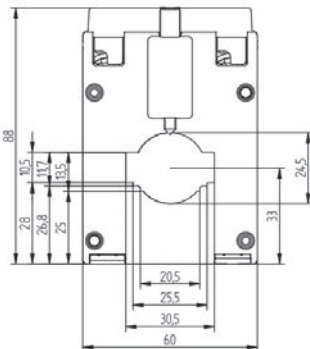
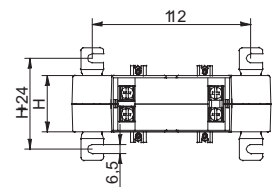

### General mechanical properties

- Nominal frequency 50 – 60 Hz
- Insulation class E (other classes on request)
- Thermal rated short-term current  $I_{th} = 60 \times I_N/1s$
- Rated surge current  $I_{dyn} = 2.5 \times I_{th}$ , min., however 100 kA with all plug-in current transformers
- Highest voltage for operating equipment  $U_m = 0.72$  kV
- Rated insulation level (test voltage) 3 kV / 1 min (per EN 60044-1)
- Over-current limit factor FS5 or FS10
- Harmonics current up to 50th harmonic
- Test report available



## Technical Data

Device overview, moulded case current transformer, class 0,2S / 5 A secondary current

Type	Primary current in A	Power in VA	Transformation ratio	Primary conductor (bus bars)	Round conductor in mm	Width in mm	Weight (kg)	Item no.
IA60B31K	150	0,1 – 2,5 VA	150/5 A	30 x 10	24,5	60	0,6	09.06.200
IA60B31K	200	0,1 – 3 VA	200/5 A	30 x 10	24,5	60	0,6	09.06.201
IA60B31K	300	0,1 – 5 VA	300/5 A	30 x 10	24,5	60	0,6	09.06.202
IA70B41K	400	0,1 – 5 VA	400/5 A	40 x 15; 30 x 30	36	70	0,7	09.06.203
IA70B41K	600	0,1 – 5 VA	600/5 A	40 x 15; 30 x 30	36	70	0,7	09.06.204
IA85B61K	1000	0,1 – 5 VA	1000/5 A	60 x 15; 50 x 30	43	85	0,7	09.06.205
IA85B61K	1600	0,1 – 5 VA	1600/5 A	60 x 15; 50 x 300 x 20	43	85	0,7	09.06.206
IA140A102	2000	0,1 – 5 VA	2000/5 A	100 x 30	3 x 30	140	0,8	09.06.207
IA140A102	2500	0,1 – 5 VA	2500/5 A	100 x 30	3 x 30	140	0,8	09.06.208